



educated
furniture
built for learning

Term 1 2020 - Primary/Intermediate School Edition

Prices exclude freight & GST. Prices may change without notice



P 0508 645 397

E sales@educatedfurniture.co.nz

W educatedfurniture.co.nz

quality ✎

value ✎

service ✎

ABOUT US

Our business was born back in 1994 (formerly known as Mike's Woodshop) when we began manufacturing children's furniture and toys from a skyline garage in Poroti, New Zealand.

Upon offering our local Whangarei schools the opportunity to purchase some painting easels, one of the local principals asked if we could custom make something similar. We took up the challenge and since then we have grown and diversified from a small product offering to a comprehensive catalogue of custom built furniture manufactured in our Whangarei based factory, along with a wide range of complementary imported and locally sourced products.

We have a skilled and loyal team who take pride in the products we deliver and who strive to provide all our customers with quality, value and service.

We have a custom built factory in Whangarei with modern machinery that produces our product to a very high standard. Over the years we have also developed an importing side to our business, whereby we can provide a number of items direct to our customers at great prices, as well as quality components to help keep our products competitive in the market. All our imported products have been very carefully selected, ensuring that they are of a higher specification than any locally made product.

We also have a range of New Zealand suppliers that complement our own furniture to ensure we have a comprehensive range available. We are very loyal to our suppliers and therefore they support us and our customers.

As a customer of Educated Furniture you have our assurance that:

- Customer service and satisfaction is our priority
- We only use and supply top quality materials and our workmanship is at the highest level.
- We will bring you the best possible products at the most competitive prices.
- We can offer a customised design service - for all areas, including the classroom, staffroom, break out spaces, offices, administration areas and libraries.
- We manufacture furniture to your specifications.
- We are always happy to assist with designing and manufacturing bespoke equipment.
- We are always researching and testing new and innovative products that we can add to our product offering.
- We are always working on ways to improve our existing products as well as coming up with completely new designs where there is a gap in the market.

COMPANY UPDATE

Hayley Watters - In October last year we welcomed our new account manager Hayley Watters to the team. She is based in Hamilton and will be covering the Central North Island. A number of our customers will have already met her but she will be progressively making her way around all the schools in her territory to introduce herself and assist our customers with their furniture needs.

Jono Mills - We're also very pleased to announce that our account manager Jono Mills made the decision to shift permanently to the lower North Island late last year. This has allowed us to further extend our account manager coverage of the North Island with Jono now responsible for servicing all schools South of Taupo to Wellington. He will be making contact with all our existing customers and developing relationships with new customers over the coming months.

Company Rebrand - As you'll notice we've now successfully completed our rebrand to Educated Furniture. Note that our email addresses and our web address have changed but all other details stay the same, including our bank account, physical address and phone numbers. If you have any queries please do not hesitate to contact our office.



Oren Ellery | Managing Director
P 09 430 8000
M 027 270 2450
E oren@educatedfurniture.co.nz



Michael McCartain | Factory Manager
P 09 430 8000
M 021 324 379
E michael@educatedfurniture.co.nz



Debby de Vantier | Office Administrator and Sales Support
P 09 430 8000
E sales@educatedfurniture.co.nz



Graham Lyons | Auckland Account Manager
P 021 537 760
E graham@educatedfurniture.co.nz



Hayley Watters | Central North Island Account Manager
M 022 398 9067
E hayley@educatedfurniture.co.nz



Jono Mills | Lower North Island Account Manager
M 021 537 740
E jono@educatedfurniture.co.nz

176 EN ONE CHAIR



\$40

- **EN-ONE3 - Years 1-2**
- Total weight 2.4kg
- Seat dimensions: H350 W335 D300
- Overall dimensions: H630 W460 D405

\$42

- **EN-ONE4 - Years 3-4**
- Total weight 2.5kg
- Seat dimensions: H380 W335 D300
- Overall dimensions: H660 W460 D410

\$50

- **EN-ONE5 - Years 5-6**
- Total weight 3.3kg
- Seat dimensions: H430 W365 D378
- Overall dimensions: H770 W500 D510

\$52

- **EN-ONE6 - Years 7-13**
- Total weight 3.5kg
- Seat dimensions: H460 W365 D378
- Overall dimensions: H800 W500 D515

Specifications:

- Re-inforced polypropylene giving strength & durability
- Lightweight and extremely durable
- Exceptional ergonomics providing users an ideal sitting position
- Stackable up to 21 chairs within a 2 metre height
- Easy to clean and no parts to maintain
- 21 year manufacturers warranty

Optional Extras:

- Optional linking device
- Stacking trolley

Choose Your Colour:



Mandarin
Orange

Night
Grey

Lime
Green

Royal
Blue



501 TEACHER WORK PODIUM

Size:

- 600W x 600D x 1000mm high (to work top)
- Plus 120mm high upstand

Specifications:

- Shaped curved top with 120mm high upstand
- Decorative front panel
- 4 outlet power box with surge protector
- Plug can exit left or right hand side
- Pull out shelf on heavy duty runners with upstand at back
- 1 heavy duty drawer 120mm deep
- 1 cupboard with 1 adjustable shelf
- 75mm heavy duty locking castors
- Complete with locks on drawer & cupboard



EC \$815

SC \$865

1 TEACHER STATION



Magnetic

Base Size

900L x 450D x 550H

Total Height

1150mm

Specifications:

- Industrial rubber wheeled castors
- Board size 900mm x 600mm
- Drawer access from both sides
- Clips on both sides



EC	\$705
SC	\$730

17 SEVEN TIER BOOK DISPLAY



Specifications:

- 1200L x 960H x 500D
- 7 tier book display
- 1 storage shelf
- Solid matching back
- Industrial rubber wheeled castors

Optional Extras: (Pinboard Backing)

- Vertiface
- Blue or Grey fabric board



EC	\$570
SC	\$595

133 BAG TROLLEY



A

Specifications:

- **A:** 1800L x 600D x 1300H
30 aluminium hooks
- **B:** 1200L x 600D x 1300H
18 aluminium hooks
- Double sided
- Industrial rubber wheeled castors
- Melteca for indoor use
- White Ply (PLY) for exterior use (suitable for covered deck or verandahs)



	EC	SC	PLY
A	\$830	\$875	\$955
B	\$585	\$620	\$660

77F ART & COLLAGE UNIT



Specifications:

- 900L x 420D x 690H
- Includes tote trays



EC	\$515
SC	\$535

77G CUBE CRATE UNIT



A

Specifications:

- **A:** 1200L x 420D x 690H
3 bins
- **B:** 800L x 420D x 690H
2 bins
- Includes cube bins

	EC	SC
A	\$550	\$580
B	\$405	\$430

48 TOTE TRAY STORAGE (4 ROWS)



Specifications:

- **A** - 900H x 1200L x 400D 32 Small Trays
- **B** - 1100H x 1200L x 400D 40 Small Trays
- Holds a combination of small and large trays
- Industrial rubber wheeled castors

Add Tote Trays

Large \$9 Small \$7
Clear, Blue, Red & Grey



	A	B
EC	\$475	\$515
SC	\$510	\$550

44 SINGLE TOTE TROLLEY



Specifications:

- 600L x 570D x 710H
- Holds 12 small trays or 6 large trays
- Double sided
- Trays accessible both sides
- Twin wheel castors

Add Tote Trays

Large \$9 Small \$7
Clear, Blue, Red & Grey



EC	\$215
SC	\$225

46 TRIPLE TOTE TROLLEY



Specifications:

- 980L x 570D x 710H
- Holds 24 small trays or 12 large trays
- Double sided
- Trays accessible both sides
- Twin wheel castors

Add Tote Trays

Large \$9 Small \$7
Clear, Blue, Red & Grey



EC	\$395
SC	\$430

45 DOUBLE TOTE TROLLEY



Specifications:

- 1390L x 570D x 710H
- Holds 36 small trays or 18 large trays
- Double sided
- Trays accessible both sides
- Twin wheel castors

Add Tote Trays

Large \$9 Small \$7
Clear, Blue, Red & Grey



EC	\$310
SC	\$335

915 WHITEBOARD CABINETS

Optimise your storage with a practical and useable storage system, customised to your individual needs. We have a range of cabinet bases that include cupboards, drawers, cube crates & tote trays which enhance your unit, with the upper levels having adjustable shelving, hiding behind the sliding whiteboards.

Pick the sizes you require to make up the overall measurement, keeping this within the 1800, 2400, & 3600mm lengths.

All units are 2000 high x 400 deep with the interior shelf depth in the top section 290mm. Some of the width sizes may vary depending on your combinations. Now also the option for the 600 deep cabinets.

The cabinet incorporates aluminium framed sliding whiteboards that have a porcelain surface, complete with a Forever Surface guarantee. You can also upgrade for the new Porcelain Projection Board.

This is a modular system that can be shipped throughout NZ, and very easily assembled on site.

All 2000h and 400mm deep

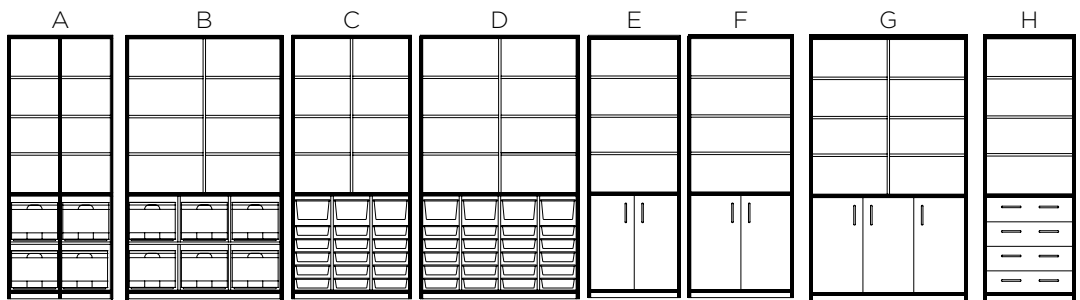

A	B	C	D	E	F	G	H
800w \$595 4 Cube	1200w \$725 6 Cube	900w \$660 3 Row Tote	1200w \$740 4 Row Tote	700w \$675 Cupboard	800w \$675 Cupboard	1200w \$890 Cupboard	700w \$785 Drawers

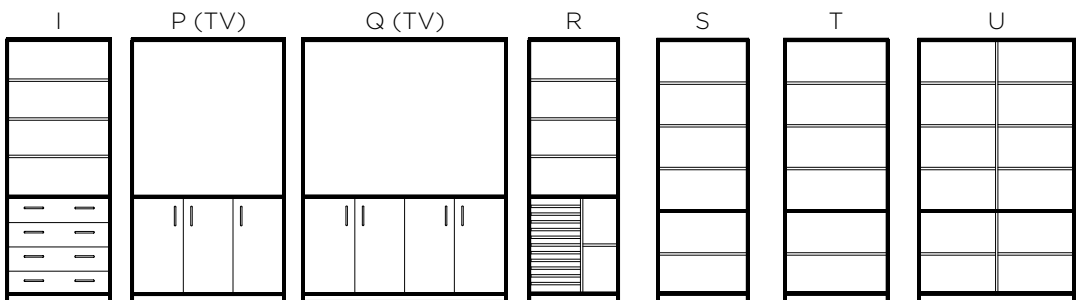

I	P (TV)	Q (TV)	R	S	T	U
800w \$840 Drawers	1200w \$910 TV Unit	1600w \$1155 TV Unit	700 L or R \$1065 Device	700w \$550 Open Shelving	800w \$560 Open Shelving	1200w \$675 Open Shelving

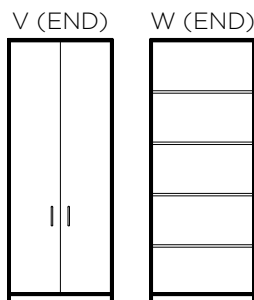

800w \$780 Cupboard	800w \$645 Bookcase
----------------------------------	----------------------------------



2400L x 2000H x 400D Pictured unit costings

2400 Whiteboards	\$1445
1 x Unit E	\$675
1 x Unit C	\$660
1 x Unit A	\$595
+ Tote Trays & Cube Bins	\$192
	\$3567



2400L x 2000H x 400D Pictured unit costings

2400 Whiteboards	\$1445
1 x Unit B	\$725
1 x Unit P	\$910
+ Cube Bins	\$90
	\$3170

NB: Excludes TV

Whiteboard Standard Sizes

1800L x 400d x 2000h - with 2 900x1200 boards	\$1360
2400L x 400d x 2000h - with 2 1200x1200 boards	\$1445
3000L x 400d x 2000h - with 2 1200x1500 boards	\$1645
3600L x 400d x 2000h - with 2 1800x1200 boards	\$1820
4800L x 400d x 2000h - with 2 2400x1200 boards	\$2220

Porcelain

EXTRAS

Locks on doors
\$45 each

Locks on drawers
\$60

Locks on whiteboards
\$100

Tote Trays -
Small \$7 | Large \$9

Cube Crates
\$15 each

Projection Boards
\$POA

600 D Cabinet
\$POA

85 CLASSROOM TABLES



Optional Extras:

- Adjustable legs - 530 - 625 - 685 - 725mm
- Tall Tables 800 & 900 high
- With 4 locking castors
- Heavy duty frame with
- 51mm round legs
- Other sizes available on request

	EC	SC	WB
800 x 600	\$160	\$170	\$225
1200 x 600	\$175	\$180	\$230
1600 x 600	\$195	\$210	\$255
1800 x 600	\$215	\$230	\$275
800 x 800	\$165	\$175	\$235
1200 x 800	\$185	\$205	\$235
1600 x 800	\$230	\$240	\$300
1800 x 800	\$265	\$280	\$340

164 SWERVE TABLES

Specifications:

- 1200 x 800 x Height required
- 18mm Melteca tops
- Solid 2mm PVC Edges
- 32mm round steel legs

Optional Extras:

- Adjustable leg - 530 - 625 - 685 - 725mm
- Tall Tables 800 & 900 high
- With 4 locking castors
- Heavy duty frame with 51mm round legs



1200 x 800

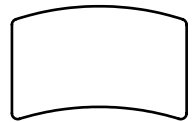

EC	\$210
SC	\$220
WB	\$270

162 HORSESHOE TABLES



Specifications:

- 1800 x 1200 x height required
- 18mm Melteca tops
- Solid 2mm PVC edges
- 32mm round steel legs

Optional Extras:

- Adjustable legs - 530 - 625 - 685 - 725mm
- With 4 locking castors

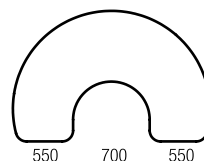

EC	\$360
SC	\$390
WB	\$450

130 TALL TABLES



Swerve Top
1200 x 800

EC	SC	WB
\$260	\$280	\$310



Sigma Top
1200 x 730

EC	SC	WB
\$270	\$290	\$315



1200 x 600

EC	SC	WB
\$230	\$240	\$275

1600 x 600

\$265	\$275	\$310
-------	-------	-------

1800 x 600

\$275	\$295	\$325
-------	-------	-------

1200 x 800

\$280	\$290	\$310
-------	-------	-------

1600 x 800

\$300	\$310	\$365
-------	-------	-------

1800 x 800

\$335	\$345	\$395
-------	-------	-------

1200 x 1200

\$310	\$330	\$380
-------	-------	-------

1200 x 1800

\$440	\$460	\$525
-------	-------	-------

1200 x 2400

\$500	\$515	\$640
-------	-------	-------

Specifications:

- 800H - Year 1-4
- 900H - Year 4-13
- 18mm Melteca tops
- Frame with heavy duty rails
- 51mm round legs



89 KNEELER TABLES



1200 x 400 x 400H

EC	SC	WB
\$115	\$120	\$150

1200 x 600 x 400H

\$175	\$180	\$230
-------	-------	-------

87 ROUND TABLES



Optional Extras:

- Adjustable legs:
530 - 625 - 685
- 725mm
- With 4 locking
castors

1900 Diameter

EC	SC	WB
\$195	\$205	\$245

200 Diameter

\$230	\$240	\$300
-------	-------	-------

170 ALPHA3 & ALPHA4 TABLES



Alpha3 Table

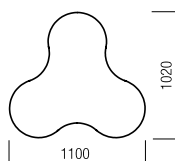

Alpha4 Table

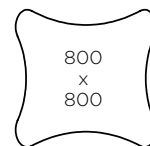

Optional Extras:

- Adjustable legs
- 530 - 625 - 685 - 725mm
- With locking castors

EC	\$215
SC	\$225
WB	\$285



Optional Extras:

- Adjustable legs
- 530 - 625 - 685 - 725mm
- With locking castors

EC	\$175
SC	\$185
WB	\$225



299 STUDY CARREL



Specifications:

- **A - Single** - 800W x 600D x 400H sides
- **B - Double** - 1600W x 600D x 400H sides
- 200mm shelf
- 32mm diameter legs
- Choose your desk height



	EC	SC
Single	\$258	\$275
Double	\$395	\$420

395 COMPUTER/LAPTOP TABLES



Specifications:

- Heights - 530 - 625 - 685 - 725 - 800 - 900
- Tops - 18mm Melteca
- Frames - 51mm ø legs with heavy 50x25 rails
- Round or square corners
- Option to add casters and/or cable ports
- Can be made to size



		EC	SC
800x600	1 computer	\$210	\$220
1200x600	1 computer	\$230	\$240
1800x600	2 computers	\$275	\$295
2400x600	3 computers	\$410	\$425

180A SUMMIT CHAIRS



Specifications:

- 25mm x 1.6mm heavy duty steel frame
- Year 3-6 size chair has a more generous seat size

Sizes	Heights	Overall width	Seat size
Year 1-2	310mm	395mm	340wx320dx320h
Year 3-4	360mm	450mm	400wx400dx390h
Year 5-6	400mm	450mm	400wx400dx390h



Black
Large Size
Only

Blue
All
Sizes

Fuchsia
All
Sizes

Lime
All
Sizes

Orange
All
Sizes



Year 1-2	Year 3-4	Year 5-6	Year 7-13
\$78	\$86	\$86	\$90
310mm	360mm	400mm	450mm

175 TITAN CHAIRS



Specifications:

- Made from virgin polypropylene
- 160kg weight rating (size 6 chair)
- Can be stacked up to 12 high
- 5 sizes available
- Generally available ex stock



Stock Colour Options:



Lime

Blue

Charcoal

Indent Colour Options:

(Approx 10-12 week delivery)



Burgundy

Green

Red

Size 2 – 310h Preschool	\$37
Size 3 – 350h Year 1-2	\$44
Size 4 – 380h Year 3-4	\$48
Size 5 – 430h Year 5-6	\$57
Size 6 – 460h Year 7-13	\$59

124 PEPPER STOOL



Specifications:

- Heights available: 450mm, 550mm, 660mm
- 25mm round solid-welded steel frame
- Polypropylene contoured seat
- Will stack 4 high



Orange

Red

Pink

Purple

Blue

Lime

Charcoal



\$99 each

117 RAINBOW CHAIRS

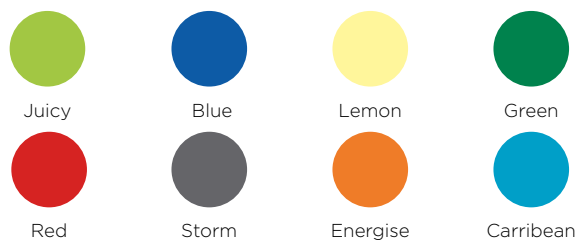

Specifications:

- Polypropylene Seat
- Heavy duty 35x16mm flat oval 25mm tube frame finished with a grey hammertone powder coat finish.
- Stackable

Options Extras:

- Chairs with arms
- Adjustable legs
- With arms & adjustable legs



Year 0-2 310 High	\$60
Year 3-4 360 High	\$64
Chairs with arms	\$99
Adjustable legs	\$125
With arms & adjustable legs	\$155

126 MLE STOOL



Specifications:

- Heights available: 400mm, 450mm, 550mm, 660mm
- 19mm square steel frame
- 45mm foam seat

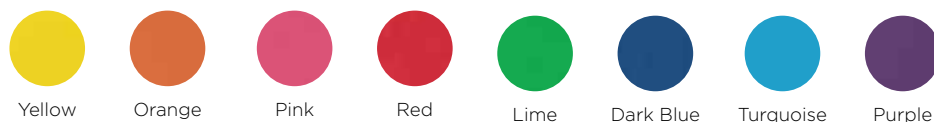

\$90 each

300 MOVE 'N' ROCK STOOL



Specifications:

- Top diameter 320mm and base diameter 330mm
- Allows rocking and tilting motion in all directions
- Durable polypropylene stool shell
- Bottom rubber padding securely screwed to stool body
- Slightly recessed seat filled with soft rubber for comfort
- Lightweight and easy to transport



Size 2 (305H) - Preschool, Year 1-2	\$99
Size 3 (380H) - Year 3-6	\$99
Size 4 (460H) - Year 7-13	\$120

472A FRITTER



Specifications

- Size - 500mm diameter x 80mm thick
- Heavy duty foam with vinyl covering
- 12 month warranty



\$60 each

234 ENVY CHAIR



Specifications:

- Overall - 500w x 550d x 830h
- Back - 480w x 350h
- Polypropylene Seat - 445w x 460h x 480h
- Stackable and linkable
- Quality chrome plated tubular frame
- Free trolley with every 40 Envy ordered



Optional Extras:

- Additional trolleys can be purchased as required

\$88 each

323 QUAD CHAIR



Specifications:

- Overall - 500w x 510d x 775h
- Back - 440w x 390h
- Durable polypropylene shell - 440w x 420d x 440h
- Stackable with generous size shell
- Quality black powder coated frame
- Free trolley with every 20 Quad chairs ordered



Optional Extras:

- Linking attachment

\$15 each

\$73 each

240 ROMA MID BACK CHAIR



2 Lever



3 Lever

Specifications:

- Overall: 630w x 600d x 1120h
- Back: 430w x 445h, Seat: 460-590h
- 130 x 48mm gas lift
- Ratchet height adjustment back/lumbar
- Adjustable seat & back rest angle - floating or lockable
- Polyurethane moulded foam & D1 nylon base
- 60mm twin wheel castors



Optional Extras:

- Height and width adjustable arms
- Polished aluminium base
- Customer specified fabric

2 Lever

\$215

3 Lever

\$240

667 LUNA CHAIR



Specifications:

- Overall Size: 640w x 640d x 1075h
- Back: 430w x 550h, Seat Size: 500w x 480d
- Breathable mesh back & high density polyurethane seat foam
- Large nylon base with 65mm castors
- Depth adjustable seat slide & adjustable lumbar support



Black

White

Optional Extras:

- Soft PU castors
- Height adjustable arms
- Customer specified fabric
- Polished aluminium base
- Chrome gas lift and Headrest



\$415 each

853 ORION TABLE



Specifications:

- 25mm Melteca tops & stainless steel base
- All 750mm high



Rectangle (2 bases)

1800 x 800	\$745
2000 x 1000	\$815
2400 x 1200	\$820

Round

900 Diameter	\$390
1000 Diameter	\$415
1200 Diameter	\$420

854 PAVO TABLE



Specifications:

- 25mm Melteca tops & stainless steel base
- All 750mm high



Rectangle (2 bases)

1800 x 800	\$745
2000 x 1000	\$825
2400 x 1200	\$835

Square

800 x 800	\$365
900 x 900	\$390
1000 x 1000	\$420

565 AGILE ELECTRONIC DESK



Frame Colours:

- Black, White or Silver powder coated finish

Specifications:

- Two column height range 680 - 1130mm
- Digital height readout with 4 point memory
- Commercial-grade 25mm worksurfaces are constructed from E1 board melamine with matching PVC edge
- Optional cable trays are available



1200W x 700D	\$755
1500W x 800D	\$799
1800W x 800D	\$850



White

Silver

Nordic
Maple

Atlantic
Oak

420 IPAD & CHROME BOOK STORAGE UNIT

Size of slot 260W x 35D x 250H - Maximum Height 425mm

2 rows - stores 16 Chrome Books 620W x 600D x 725H

3 rows - stores 24 Chrome Books 840W x 600D x 725H

4 rows - stores 32 Chrome Books 1175W x 600D x 725H

EC

SC

\$900

\$925

\$1140

\$1165

\$1400

\$1460

2 Row Unit



3 Row Unit

Specifications:

- Mount your Powerpack & plugs on the back and thread the plugs through the cable port holes
- Looks like a cupboard, not like it has \$1000's of iPads in
- Complete with locks

ADD POWER PACKS (IF REQUIRED)

Includes surge protection

2 Row Unit **\$160**

3 Row Unit **\$180**

4 Row Unit **\$200**



401 LAPTOP STORAGE 12 & 15'S



We can add the power boards if required - including surge protection

12 **+ \$160**

15 **+ \$180**

Specifications:

- Heavy duty locking castors bolted through base
- Holes for all cabling including power cables at back
- Heavy duty handle on 1 end
- Grills for ventilation
- Holds 15 - 800L x 1180H x 500D - Slot size - 395W x 395D x 50H
- Holds 12 - 800L x 1100H x 500D - Slot size - 395W x 395D x 60H



EC

SC

12 Slot **\$1095** **\$1140**

15 Slot **\$1175** **\$1240**

400 LAPTOP STORAGE 24 & 30'S



We can add the power boards if required - including surge protection

24 **+ \$180**

30 **+ \$200**

Specifications:

- Heavy duty locking castors bolted through base
- Holes for all cabling including power cords at back
- Heavy duty handle on 1 end
- Grills for ventilation
- Holds 24 - 1200L x 1100H x 500D - Slot size - 395W x 395D x 60H
- Holds 30 - 1200L x 1180H x 500D - Slot size - 395W x 395D x 50H



EC

SC

24 Slot **\$1420** **\$1505**

30 Slot **\$1560** **\$1630**

Educated Colours (EC)

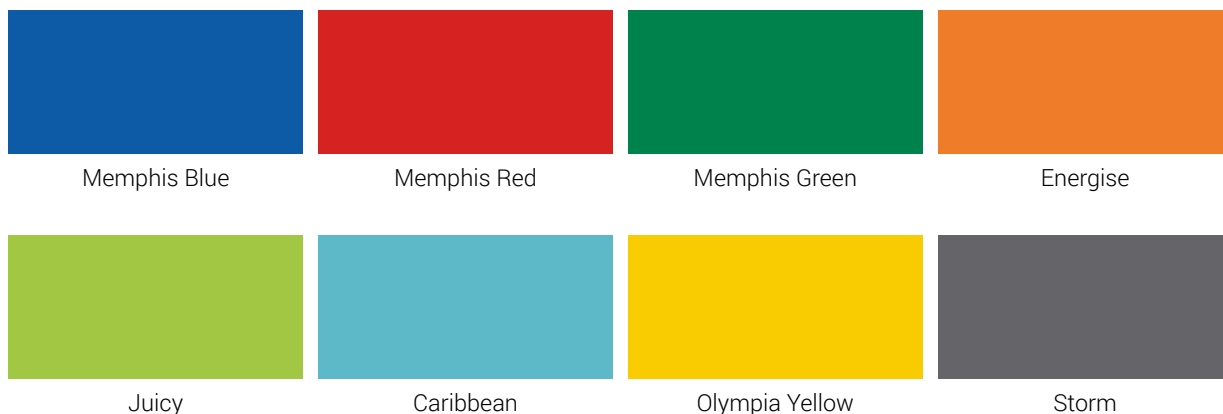

Standard Colours (SC)



Please note that colours pictured are as close to specification as the printing process will allow. Prices listed in this flyer are only for the above colours or colours specifically listed beside a product. For additional fabric/colour options please refer to educatedfurniture.co.nz/furniture-colours-fabrics/



63 South End Avenue
PO Box 11089
Whangarei 0148

Contact us for a quote

E sales@educatedfurniture.co.nz

P 0508 645 397

educatedfurniture.co.nz